



AUSTRALIA'S MOST AWARDED LUXURY BOAT BUILDER



4400 SPORT YACHT SERIES II | THE ULTIMATE RIVIERA

EDITION 15.2

INNOVATIVE THINKING FOR UNRIVALLED PLEASURE

In our proud history we have produced many new yachts, but none has challenged traditions or questioned the assumptions on which boats are generally built quite like our Sport Yacht collection.

This is especially true of the Riviera 4400, a boat rich in innovation.

The story starts with the revolutionary Volvo Penta Inboard Performance System (IPS), a technology that features steerable drive units with counter-rotating, forward-facing propellers. Rather than 'pushing' the boat along as with conventional propulsion, the boat is literally 'pulled' forward through clean and undisturbed water.

The result is superb handling, a remarkably tight turning circle and thanks to an intuitive joystick, docking control and other close-quarter manoeuvres are delightfully easy. What's more, IPS uses up to 30% less fuel than conventional drive systems.

With the standard diesel horsepower ratings available, you can also look forward to a thrilling ride: racy, responsive, yet soft and dry.

The hull is equally noteworthy. Not only is it designed using the latest CAD software, which contributes to the outstanding hydrodynamics of the hull, internally the hull is divided into three compartments – including a collision bulkhead forward.

Given the contemporary styling, sumptuous comfort and long list of luxuries that are to be found on board the 4400, you will no doubt be tempted to cruise far from the madding crowd – and with a 1,500 litre (396 US gallon) fuel tank, it is certainly equipped to help you do just that. However, it is knowing that this is a vessel with impeccable structural integrity, a vessel that can handle the vicissitudes of life at sea, that makes it possible to sit back and truly relax.





BOLD DESIGNS AND IMPRESSIVE DETAILS

One of the most dramatic and pleasing features of the 4400 is the huge, stainless-steel framed awning window and door between the cockpit and saloon. Once open, the free flow between the two areas not only creates a refreshing, relaxed ambience, but is also immensely practical.

In the cockpit you can stretch out on a generous lounge and take advantage of a table that adjusts (ram assisted) to serve as a dining table, coffee table or day bed.

Fenders or other bulky equipment can be neatly stowed away in the enormous storage locker in the rear of the transom. The swim platform has also been thoughtfully designed with a concealed swim ladder and can be fitted with an optional hydraulic lift.

Even access to the engines has been carefully considered. There's a service hatch in the forward area of the cockpit for general inspections and a large section of the cockpit floor can be raised – using a remote-activated electric control – for full engine-room access.

For our designers, details make all the difference and they are forever asking how they can make life on board as smooth and pleasurable as possible. Take the sun pad on the foredeck: it has safety rails and drink holders, it comes with a cover, is self-draining and has a wind deflector incorporated at the front edge to prevent lifting in a breeze or when cruising at speed. Access to the foredeck is also that much safer and easier by virtue of wide walk-around side decks with courtesy lights on the steps either side of the cockpit.

1. The cockpit has excellent protection from the elements with a generous overhang and optional rear awning. 2. and 3. Fixed and casual seating in the cockpit gives flexibility when entertaining. 4. The large foredeck features a double sun lounge and plenty of space for fun in the sun.





EASY LIVING, RIVIERA STYLE

In the saloon, the sense of space and light created by opening the saloon door and awning window is enhanced by a huge, electrically operated sunroof and large, tinted, side sliding windows. Combined with contemporary fittings and finishes – such as high-quality timber finish flooring and high-gloss American Cherry cabinetry – you have a stylish, ultra-modern interior.

A well-equipped interior it is too. There's a deep leather lounge, adjustable hi-lo table, plenty of storage, a liquor cabinet, a first-class entertainment centre including a large LCD TV... and a galley with all the equipment, cupboard and bench space you need to entertain in style or simply escape the everyday and relax.

The layout of the helm, the visibility of the instrumentation and the view afforded by the massive windscreen (complete with freshwater washers and pantograph wipers) inspires confidence. And all from the comfort of a high-backed, electrically adjustable, leather-upholstered helm chair.



1. Luxurious, sports-inspired helm station has two individual, adjustable helm seats and ample space for large electronic navigation screens. 2. The ultimate alfresco dining – under the stars courtesy of the large electric sunroof. 3. The foredeck features a double sun lounge – the perfect place to enjoy the sun or a great book. The sun lounge features adjustable back and head rests that make relaxing, more relaxing.



Below decks you will find a wide companionway with a full-height pantry or linen cupboard and room for optional appliances. Then there's the full-beam aft stateroom: one of the major benefits of IPS is the space savings that it creates, and as a result this is a surprisingly large guest stateroom that easily accommodates a single berth and queen bed, together with ample wardrobe space.

With dual entry, the bathroom serves as both an ensuite and dayhead. Like the ensuite that services the master stateroom, this is a thoroughly modern space with frameless glass shower-stall door, raised basin and high-quality tapware.

The master stateroom itself is most luxurious. From the comfort of the queen island bed with its innerspring mattress to the cedar-lined lockers and large hull port light windows and deck hatch, this is a stateroom that caters for the most discerning boat owner.



1



2



2

1. The master stateroom includes a queen size walk-around bed with plenty of storage and hanging space. 2. Cedar-lined hanging lockers help keep stored clothes fresh. There is an abundance of storage through-out the 4400. 3. Generous size dinette features a fold out table for elegant dining. 4. Fully equipped galley has refrigeration, dishwasher, microwave and recessed two burner hot plates with ample storage close to hand. The galley is positioned aft - central to the saloon and cockpit, just perfect for entertaining. 5. The spacious full-beam aft cabin is light and airy, with a large double bed to port and a single bed to starboard. 6. The television in the saloon is discreetly hidden away in the forward cabinetry via an electric riser system.





1. Day head/aft cabin ensuite. 2. The laundry/linen press area can be customised to suit owners requirements with an optional freezer unit fitted above the washer/dryer. 3. The master ensuite features stylish Amtico flooring, solid-surface benchtops and fashionable glass bowl. Shower stalls have frameless doors and satin chrome shower fittings. 4. Two steps on either side of the cockpit with teak treads and courtesy lights make access to side and fore decks simple and safe. 5. The entire cockpit floor lifts on a hydraulic ram to provide easy access to the engine room. 6. A generous locker incorporated into the transom has plenty of space for fenders, equipment and water toys. 7. Ample space is provided around the engines for service and maintenance.



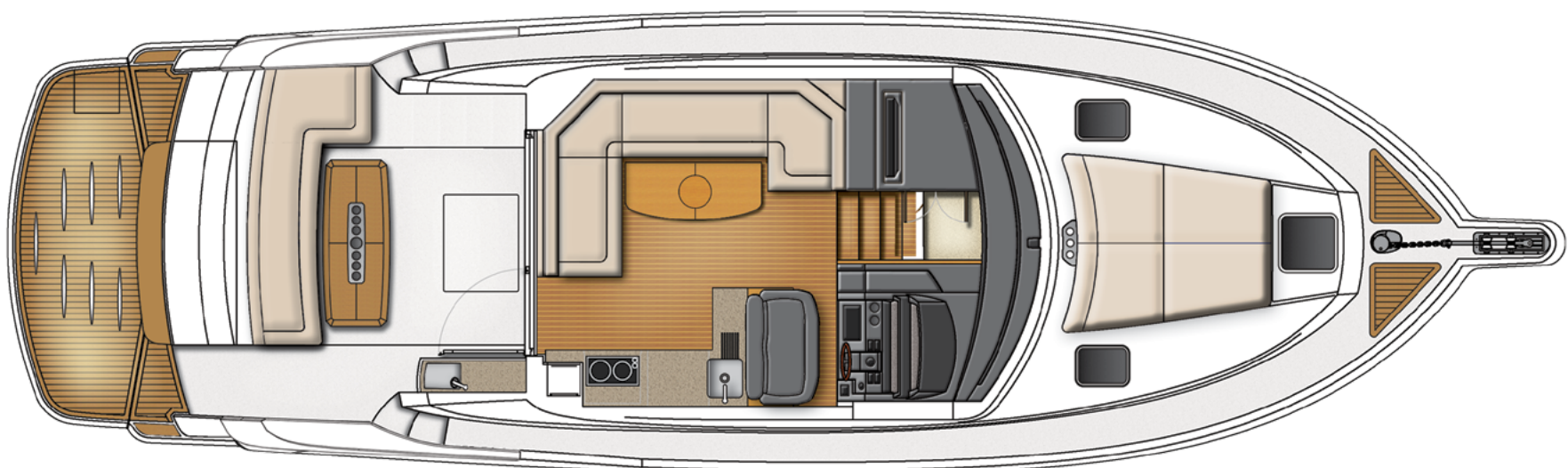
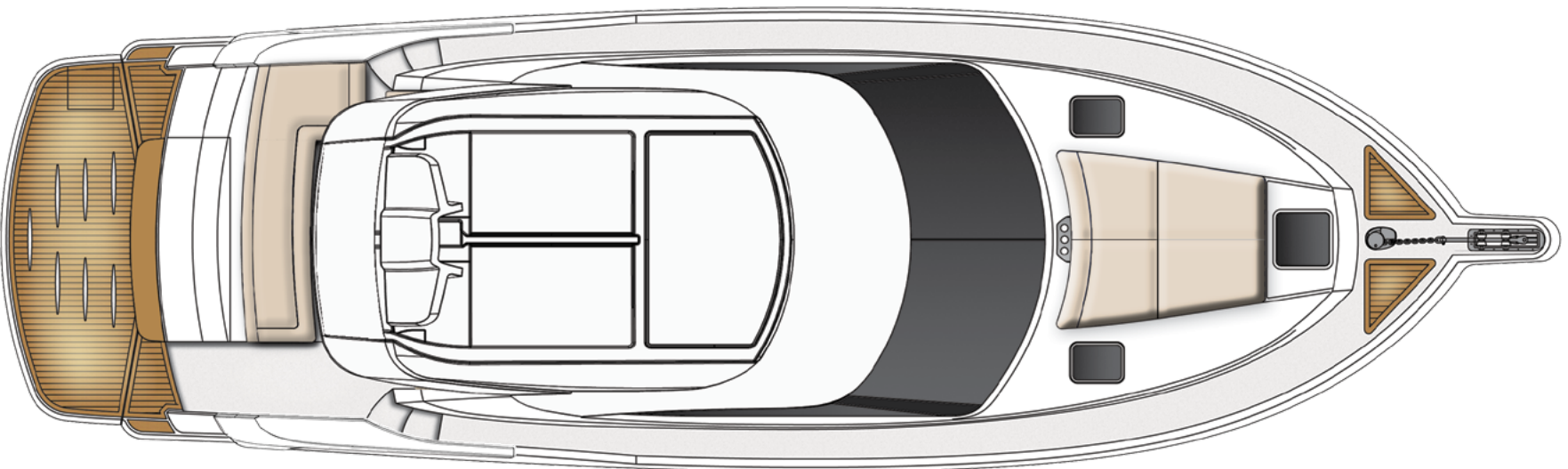

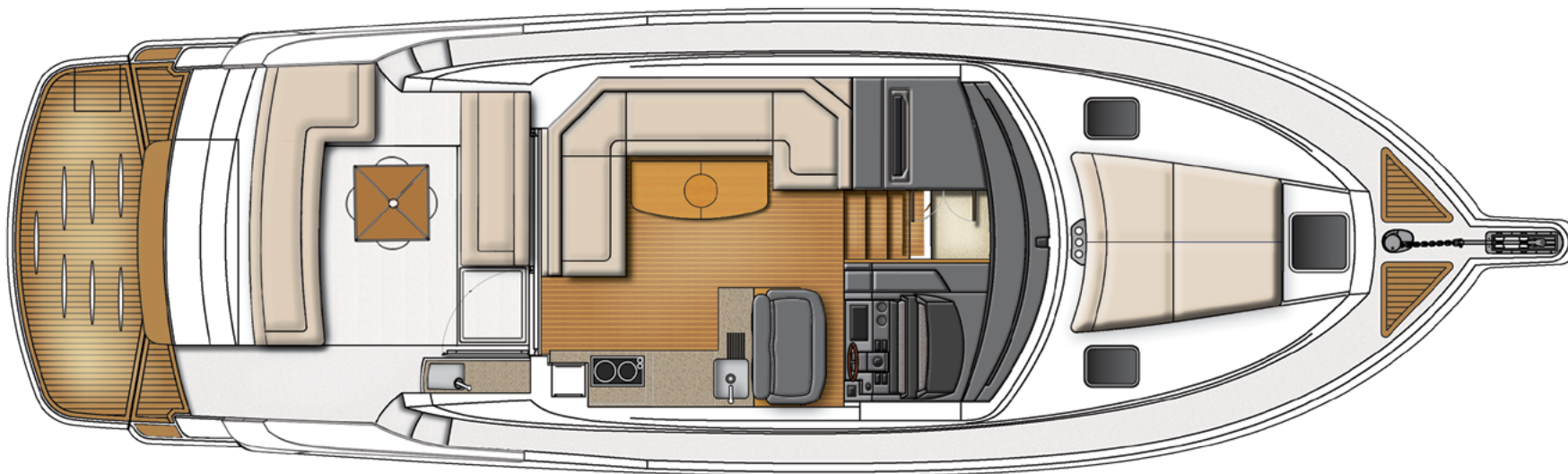

Optional aft facing seat and
hi-lo folding leaf table



CRAFTED WITH PASSION

Riviera is an Australian success story and a major international marketer of luxury motor yachts. Our growth over more than 35 years has resulted in a company that today creates and manufactures five individual model collections and supports an international dealer network that spans more than 60 countries. We are also Australia's most-awarded pleasure yacht manufacturer.

The secret of our success is an absolute commitment to quality. Be it our 480-strong team of people, our work practices, materials, tools and technology, environmental responsibility or after-sales service, we are rigorous in pursuing the highest standards.

Our craftspeople consult world-leading naval architects, engineers and designers. Our employment and training practices have also earned us many local and national awards.

Riviera operates the largest luxury yacht building facility in the Southern Hemisphere which boasts some of the most sophisticated technology available.



AWARDED FOR EXCELLENCE

Riviera's vast collection of industry awards is a reflection of the pride and passion our master craftsmen put into every model in our premium range of Australian-built luxury motor yachts.





The home of Riviera. The 14-hectare state-of-the-art manufacturing facility on the Gold Coast in Queensland. This is the largest facility of its kind in the Southern Hemisphere. Each year in May, this world-class facility plays host to the educational and fun-filled Riviera Festival of Boating and the enormous Gold Coast International Marine Expo.

RIVIERA'S ETHOS INSPIRES CONFIDENCE

The quality of our service is commensurate with the quality of our yachts and is something about which we are extremely passionate. The experience of purchasing your Riviera, from the selection of the electronics and décor to the regular service and maintenance, will all be carried out reliably, promptly and smoothly. In fact, you can count on us, and our global dealer network, for the life of your yacht.

It is this consistent quality that has created Riviera's enormous and ever-growing international appeal.

Today, almost 5,200 Riviera luxury yachts can be seen cruising the seas, oceans, lakes and rivers of the world.

A sensational and growing choice of models, an impeccable pedigree, excellent value and outstanding service: now more than ever, Riviera's reputation for quality with integrity inspires confidence in boating enthusiasts the world over.

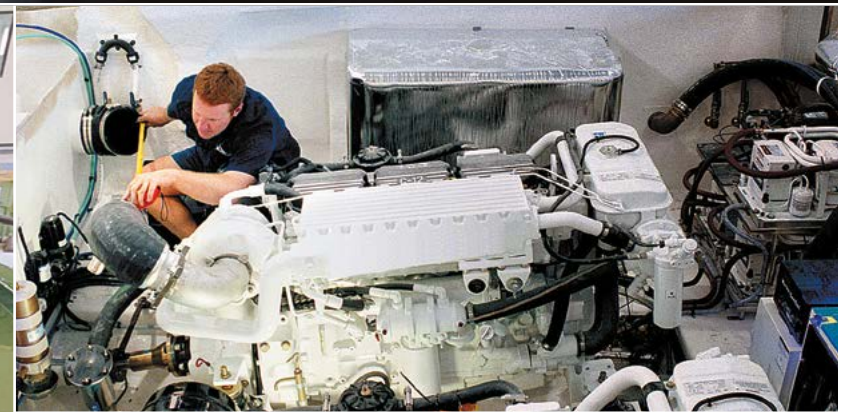



The growing Riviera global network of dealers now spans 60 countries. Find a dealer near you at RivieraAustralia.com





Electronics play an ever-increasing role in the pleasure, performance and safety of luxury boats, and the choice of equipment that is available today is vast. In fact, selecting the equipment that meets your needs can be a very challenging task. R Electronics is here to help: we source the best systems and products from around the world; we are experts at matching technology to individual requirements and work closely with Riviera's design team and Riviera's global Dealer Network to create systems that maximise your pleasure and safety.

RElectronics.com.au



A passion for quality and good design steers everything we do at Riviera — and this is reflected in our exclusive range of clothing, accessories and decor items. If you love your Riviera, you'll feel at home with the Riviera Collection: casual yet stylish, comfortable, practical and made to withstand the rigours of boating life.

The Accessory and Decor Collection ranges from a storm jacket to stylish crockery. To make your luxury Riviera or Belize truly your own, we offer a wide choice of fabrics, finishes and color schemes that allow you to customise your yacht. Of course, we also have experienced designers who can advise and assist with your individual selection.

It is a real pleasure to own and use things that are aesthetically pleasing, work well and last — and because it is only appropriate that such qualities are found on board a Riviera, we supervise each individual interior scheme from creation to installation.

Riviera has the total leisure and style solution.

RivieraParts.com.au





THE RIVIERA EXPERIENCE

When you buy a Riviera, you are really joining a family.

Indeed, this "Riviera Experience" is something we take very seriously and value very highly – we believe our core duty is to help owners of our world-class, Australian-built luxury motor yachts to achieve *"the ultimate boating experience"*.

So you can imagine how proud we are that this commitment is something highly valued by members of our Riviera "family" of owners too.

With exclusive invitations to special adventures, social events and educational workshops, the "Riviera Experience" runs much deeper than owning a striking, sophisticated and stylish motor yacht which not only looks a cut above the rest but also delivers in terms of superior sea-handling and innovative on-board technology.

Perhaps our passion is best reflected in the words of our Riviera owners:

"I had not even turned the key on my new 445 and I already felt part of the Riviera family. I've owned a number of boats and maybe I'm a slow learner ... I should have bought a Riviera earlier!"

"We really enjoy coming together as the Riviera community. We've been on a couple of the Experience trips and there's a real safety aspect of going offshore and being around other Riviera owners, who know their boats and your boat too."

And one more ...

"Riviera goes over and above all expectations to make sure owners enjoy a great experience for the entire life of their boats. That lifelong commitment is something that really makes a difference."

Yes, they are glowing endorsements and they are all from valued Riviera owners who share something unique – they share the truly unrivalled "Riviera Experience".



4400 Sport Yacht

SPECIFICATIONS

Length Overall (inc. swim platform and bow sprit)	15.12 m	49' 7"
Lh to ISO8666 *	13.91 m	45' 8"
Beam (inc. gunwale)	4.58 m	15' 0"
Maximum Draft (inc. props)	1.11 m	3' 8"
Dry Weight ** (approx.)	13,850 kg	27,500 lb
Fuel Capacity ***	1,500 L	396 US gal
Water Capacity	460 L	122 US gal
Holding Tank Capacity	151 L	40 US gal
Sleeping Capacity	5 persons	
Cockpit Area	4.90 m ²	52.7 ft ²
Bridge Clearance	2.99 m	9' 10"
Standard Engine	320 kW	435 hp each
Volvo Penta IPS600 D6 x 2		

Riviera Clarification of Specification

*Length of the hull (Lh) to ISO8666: Includes all structural and integral parts (ie. the moulded length of the hull). It excludes parts that can be removed in a non-destructive manner without affecting the structural integrity of the craft, eg. pulpits, outdrives, driving platforms, rubbing strakes.

**Dry weight represents the estimated minimum weight of a boat with standard engines and options, no fuel or water on board, no equipment or provisions and no personnel. The stated dry weight may be exceeded.

***Denotes net tank capacity. For useable capacity do not rely on more than 90% of tank capacity. Actual capacity will vary according to boat trim and sea state.

Speeds are subject to normal weather conditions, fuel and/or water levels, passengers and equipment loads.

Refer to your Riviera Owner's Manual and your Dealer for height to hardtop and maximum height details.

The specifications in this document are not complete or definitive and are subject to change without notice and therefore may not be current. Riviera will not be liable (in contract, tort or otherwise) for any loss resulting from the inaccuracy of any information contained in this document.

Specifications may vary on a regional basis. Some images in this brochure may include non-standard or after-market options.

Warnings

Riviera is committed to building the best luxury cruisers, tailored to suit specific countries and their individual compliance laws and regulations. Riviera equipment and build specifications approved for one country may not be compliant with another country's safety and equipment regulations and as such those cruisers may have no recourse to Riviera extensive manufacturer's warranties.

Each country and State has different safety equipment standards.

It is important that you ensure the requirements in your jurisdiction are met prior to the vessel being used.

Our PASSION

To create the *ultimate*
boating experience.

