



RIVIERA 70 ENCLOSED FLYBRIDGE | THE ULTIMATE RIVIERA



RIVIERA

NOW GOING TO GREATER LENGTHS

The brief was simple: create the largest, most luxurious and technically advanced Riviera ever. For our designers, engineers and craftspeople, it was an invitation to express their talent and creativity like never before - and they responded magnificently.

This is not surprising as the team included some of the foremost figures in the boat-building world, such as the internationally renowned superyacht architect Frank Mulder, responsible for the extraordinary running service of the hull.

The creation of our new flagship was the opportunity to capitalise on decades of boat-building experience and the lessons learnt from having crafted over 4,500 luxury vessels. The Riviera 70 Flybridge has also been developed at a facility that houses some of the world's most sophisticated marine technology, including the latest Computer Assisted Design software.

Craft of this calibre are clearly destined for the fortunate few - and typically those with very discriminating tastes and a wealth of boat-ownership experience.

The task of impressing those not easily impressed meant rigorously inspecting competing craft and, simply, asking how could we do it better? With greater comfort, a better build, superior performance, more standard inclusions... we believe we have excelled in every category.

We hope this introduction inspires you to step aboard and discover the Riviera 70 Enclosed Flybridge for yourself.





A SAFE HULL AND A SENSATIONAL RIDE

The safety, comfort and performance of any vessel is contingent on the design and manufacture of the hull, and this is particularly important with large, long-range vessels as they are more likely to encounter big seas and challenging conditions.

The Riviera 70 falls into the serious long-range category (the 8,000 litre/2,110 US gal fuel tank is a testament to this) and we have created a hull that is more than up to the task.

It is a hand-laid structure featuring solid fibreglass below the waterline and a watertight collision bulkhead forward; and the extensive use of lightweight, cored bulkheads throughout the hull provide exceptional structural integrity with minimal weight. Issues of durability and access for maintenance have also been carefully considered in its development.

As for performance, this is a dream hull. It is as racy and responsive as it is robust and reliable. Features like tunnels that house the propeller shafts contribute to a lower shaft angle that delivers impressive thrust, is quick to plane and offers a smooth, dry ride.

Engine options range from standard twin diesel Caterpillar C32 (1,156 bkw/1,572 mhp) to twin diesel MTU 12v Series 2000 M93 (1,340 bkw/1,823 mhp). So the choice is really somewhere between exhilarating and absolutely thrilling.



1



2

1. The flybridge helm console has been ergonomically designed and can house up to five 19" display screens together with the full complement of communications equipment. 2. The engine room is an engineering masterpiece. Excellent access to all machinery and systems has been a key design consideration.



GENEROUS AND INGENIOUS

If there is one question that characterises Riviera, it is "how can we make your boating experience more pleasurable?" And the answer has never been more richly expressed than on the Riviera 70 Enclosed Flybridge.

You expect a freshwater-maker, but maybe not one that delivers 284 litres per hour. Of course, your utility room would come with a washing machine and tumble drier (and Miele in our case), but an optional temperature-controlled wine cooler may come as a surprise.

With five Bose entertainment systems and LCD TVs, who watches what, where and when will never be an issue. With three independent air-conditioning units, keeping your cool shouldn't be a problem either. You might also appreciate the four built-in vacuum cleaners or even the abundance of rod storage compartments.

How sensible it is to have contemporary Amtico flooring in the galley and flybridge, how pleasing to have European design light fittings and, for the technically minded, how reassuring to have such sophisticated power control and back-up systems.

The quality of the stainless-steel exterior rails and smooth finish to the welds; the perfect, mirror-like gloss of the internal timberwork; the advanced bow thruster or state-of-the-art trim tabs... wherever you look we have anticipated your needs and catered to your every comfort with thoughtful design, impeccable craftsmanship and superior technology.



3



4



5



6



7



8

9. The flybridge aft deck features a lounge and optional dinette table. The aft bulkhead window lifts up and out on gas struts to open the bridge to the large aft deck.



9



10



11



MAKING MORE OF THE GREAT OUTDOORS

The cockpit is a spacious and flexible playground for you, your family and friends. However, the clean, unencumbered styling conceals a host of smart features.

Fishing enthusiasts will be pleased to know that the floor is reinforced with an alloy plate for a game chair and, in addition to several storage bins, an optional live-bait tank can be fitted in the transom. Toe kicks are also moulded into the bottom of the coamings.

For alfresco dining, an electric barbecue is built into the mezzanine floor together with a eutectic freezer, icebox and sink. Importantly, there's ample storage room for tables and chairs alongside all that fishing and diving gear!

The luxurious aft-facing lounge on the mezzanine level is an ideal position for watching the fishing action or to simply relax with a cocktail. There is also the option of a mezzanine dining deck.

Other little inclusions like a hot and cold freshwater shower and courtesy foot lighting make life in the cockpit as free and easy as possible.

For serious sunning or maybe quiet contemplation, nothing beats the sense of space and freedom on the massive foredeck. A recessed area in the deck can also accommodate a tender, making it more secure and less obtrusive from the side profile.



12



13



14

12. Beneath the mezzanine lounge a two-door fridge/freezer can be fitted. To the right of the fridge unit is the engine room access door. 13. The large saloon rear window swings out and up on two gas struts to connect the saloon and mezzanine/cockpit as one huge entertaining space. The large opening window provides additional saloon ventilation and is strong source of natural light. 14. The aft cockpit coaming can have an optional electric BBQ hot plate fitted.

A FLYBRIDGE TO LOOK UP TO

With its stunning views, lounge-room comfort, first-class entertainment system and wet bar, you will rarely be alone in the flybridge – especially given the ease of access thanks to the internal stairway from the saloon.

A large L-shaped lounge, plus Ottoman, offers supreme comfort within and an aft deck lounge provides comfort and distant vistas without. There's also an aft deck docking station complete with Edson steering wheel, engine and thruster controls.

If your party wants to party, the flybridge is well equipped with an icemaker, refrigerator and glass and bottle storage unit. Guests can also join you at the helm courtesy of two Pompanette Platinum companion chairs - that is in addition to the skipper's electrically adjustable Pompanette chair.

Three massive pantograph wipers and freshwater washers ensure optimum visibility through the forward window and there is the option of opening side windows if you are a fan of fresh air.

A huge electrically operated sunroof also enhances that delightful indoor-outdoor ambience.

The helm features comprehensive electronic instrumentation and vessel controls together with ample space for your factory-fitted customised equipment. Riviera offers the full range of electronics, from fishfinders and chartplotters to underwater lights and GPS systems.

However, the compass, VHF radio, intercom system and feed for cameras in critical locations are all standard... and all contribute to the smoothest, most enjoyable of voyages.



15. The rear bulkhead window in the flybridge lifts out and up on gas struts to open the flybridge to its aft deck. 16. The forward helm position can accommodate up to three captains chairs. 17. The flybridge also contains a full entertainment centre. 18. The aft deck of the flybridge has a generous overhang for all weather protection. There is a lounge to port and aft steering station to starboard. 19. The flybridge galley/wet bar can be equipped with microwave oven, drawer fridge and dishwasher. 20. The flybridge galley/wet bar is ideal for passage-making or whilst underway to save crew members having to carry food or refreshments from the galley downstairs to the flybridge.



15



16



17



OUR ULTIMATE INTERIOR

Welcome to a thoroughly modern saloon, one in which light and space and subtle styling produce an atmosphere of ease and understated elegance.

Huge windows, an outward opening door to the cockpit and a large awning-style window above the cockpit mezzanine contributes to this light and airy character.

Electrically operated day/night blinds and creative lighting also allows you to set the mood.

Lazing on that enormous leather-clad lounge watching a movie on the 42" LCD TV, or listening to your Bose Lifestyle 48 audio system, you are truly in the lap of luxury. And a liquor cabinet complete with fridge and icemaker is at hand should refreshment beckon you.

Those with a culinary flair will appreciate the latest European appliances in the galley, along with granite benchtops, a built-in water purifier and copious amounts of cupboard and draw space.

Given that this is a galley in which you can create gourmet fare, it is only appropriate that it is eaten in style. The elevated dining area has its own relaxed ambience and features a large, beautifully finished dining table and eight freestanding, leather-upholstered chairs.

If your definition of the good life revolves around sharing leisure time with the people closest to you, there is no better environments more conducive than the Riviera 70.



21. The large galley features ample bench space and can be customised in many ways. 22. The saloon dining area can also be customised with either free-standing or fixed furniture or a combination of both.



STATE OF LUXURY STATEROOMS

Depending on your choice of cabin configuration, the 70 offers accommodation for up to 10 people in four cabins – all in exceptional comfort.

The full-beam Master Stateroom is unashamedly indulgent. It starts with a king-size walk-around bed complete with a latex mattress; there are his and hers walk-in wardrobes with cedar linings and automatic lighting; there is even a two-seater couch, a writing bureau and, for your entertainment, a 32" LCD TV and five-speaker sound system.

There are numerous pleasing little touches too, such as the deep plush carpet, full-length dressing mirrors, reflective mood lighting around the bed, and the inclusion of a safe for your valuables.

Every cabin has an en suite with the port cabin also serving as a day head.

As you might expect, these are no ordinary bathrooms. Here you will be treated to quality quartz floor tiles, contemporary marble vanity tops with porcelain bowls; the toilets are all full sized, freshwater models; the shower stalls have modern, frameless glass doors; the shower and tapware is of the highest standard; and every en suite has a heated towel rail.

It is this relentless obsession with detail, with quality, with good design, with making your boating experience the best it can possibly be, that makes the Riviera 70 simply the finest boat in its class.



23. Optional forward cabin arrangement with twin, two bed cabins.
24. The starboard VIP guest cabin. 25. The Master Stateroom en suite.
26. Custom port guest cabin. In this configuration featuring three single beds. 27. The day bathroom/guest cabin







ELECTRONICS

Electronics play an ever-increasing role in the pleasure, performance and safety of luxury boats, and the choice of equipment that is available today is vast. In fact, selecting the equipment that meets your needs can be a very challenging task. R Electronics is here to help: we source the best systems and products from around the world, we are experts at matching technology to individual requirements and work closely with Riviera's design team and Riviera's global Dealer Network to create systems that maximise your pleasure and safety.

www.relectronics.com.au



STYLE

A passion for quality and good design steers everything we do at Riviera — and that is reflected in our exclusive range of clothing, accessories and décor items. If you love your Riviera, you'll feel at home with the Riviera collection: casual yet stylish, comfortable, practical and made to withstand the rigours of boating life. You'll find extensive use of natural fibres, including 100% cotton, quality zippers and first-class workmanship in details such as contrast stitching.

The accessory and décor collection ranges from a watch that can weather the storm to stylish crockery. Riviera has the total leisure and style solution.



INTERIORS

To make your boat truly your own, we offer a wide choice of fabrics, finishes and color schemes that allow you to customise your Riviera. Of course, we also have experienced designers who can advise and assist with your individual selection.

It is a real pleasure to own and use things that are aesthetically pleasing, work well and last — and because it is only appropriate that such qualities are found on board a Riviera, we supervise each individual interior scheme from creation to installation.

www.rinteriors.com.au



BOATS THAT REFLECT A CULTURE OF QUALITY

Riviera is an Australian success story and a major international marketer of luxury pleasure boats. Our growth over more than 29 years has resulted in a company that today produces around 150 such vessels annually. We are also Australia's most awarded pleasure boat manufacturer.

The secret of our success is an absolute commitment to quality. Be it people and work practices, materials, tools and technology, environmental responsibility or after sales service, we are rigorous in pursuing the highest standards.

Our craftspeople consult with world-leading naval architects and engineers, and operate a world-class apprenticeship training program. Our employment and training practices have also earned us many local and national awards.

Riviera operate the largest luxury boat building facility in the Southern Hemisphere and boasts some of the most sophisticated technology.

The quality of our service is commensurate with the quality of our boats and is something we are passionate about. The experience of purchasing your Riviera, from the selection of the electronics and décor to the maintenance, repairs and refits will all be carried out reliably, promptly and smoothly. In fact, you can count on us, and our global Dealer Network, for the life of your boat.

It is this consistent quality that has created Riviera's enormous and ever-growing international appeal.

Today we have dealerships in over 30 countries and, due to our success in the USA, we also have a team and headquarters in Florida.

A sensational and growing choice of vessels, an impeccable pedigree, excellent value and outstanding service: now more than ever, Riviera's reputation for quality with integrity inspires confidence in boating enthusiasts the world over.

Riviera 70 Enclosed Flybridge Specifications

Length Overall (inc. swim platform & bow roller)	23.34 metres	76' 7"
Lh to ISO8666*	22.07 metres	72' 5"
Beam (inc. gunwale)	6.32 metres	20' 9"
Maximum Draft (inc. props)	1.7 metres	5' 7"
Dry Weight** (approx. depends on engines & options)	41,920 kgs	92,418 lbs
Fuel Capacity***	8,000 litres	2,110 US gal.
Water Capacity***	1,000 litres	264 US gal.
Water Maker (per hour)	284 litres	75 US gal.
Holding Tank Capacity***	500 litres	132 US gal.
Sleeping Capacity	10 - 14 persons	
Standard Engines x 2 Caterpillar	1,156kW	1,572 hp
Generator Onan EQD x 2	22.5kW	

The Riviera Group Warranty

Riviera warrants to the first retail purchaser during the periods herein that it will, subject to the terms and conditions in the full Riviera Group Warranty, replace or repair, at its option, defects caused by faulty workmanship or materials under normal use and service during the first twelve (12) months and (5) years for hull structure. Please refer to your Riviera Owner's Manual and your Riviera Dealer for full details of the comprehensive Warranty.

Due to The Riviera Group's commitment to continually improve our products, we reserve the right to modify or change, without notice, any materials, specifications, equipment and/or accessories. All measurements quoted are approximate and pictures and drawings displayed are indicative only.

Riviera is the owner of the copyright material (including the photographic material) contained in this brochure and any reproduction of any part thereof without the express licence of Riviera may infringe this right.

The Riviera Group Clarification of Specification

* Length of the hull (Lh) to ISO8666: Includes all structural and integral parts. (ie. the moulded length of the hull.). It excludes parts that can be removed in a non-destructive manner without affecting the structural integrity of the craft, eg. pulpits, outriggers, diving platforms, rubbing strakes.

** Dry weight represents the estimated minimum weight of a boat with standard engines and options, no fuel or water on board, no equipment or provisions and no personnel. The stated dry weight may be exceeded.

*** Denotes nett tank capacity. For usable capacity do not rely on more than 90% of tank capacity. Actual usable capacity will vary according to boat trim and sea state.

Speeds are subject to normal weather conditions, fuel and/or water levels, passengers and equipment loads.

Refer to your Riviera Owner's Manual and your Dealer for height to hardtop and maximum height details.

The specifications in this document are not complete or definitive and are subject to change without notice and therefore may not be current. Riviera will not be liable (in contract, tort or otherwise) for any loss resulting from the inaccuracy of any information contained in this document.

Specifications may vary on a regional basis. Some images in this brochure may include non-standard or after-market options.

Warnings

The Riviera Group is committed to building the best luxury cruisers, tailored to suit specific countries and their individual compliance laws and regulations. Riviera equipment and build specifications approved for one country may not be compliant with another country's safety and equipment regulations and as such those cruisers may have no recourse to The Riviera Group's extensive manufacturer's warranties.

Each country and State has different safety equipment standards. It is important that you ensure the requirements in your jurisdiction are met prior to the vessel being used.

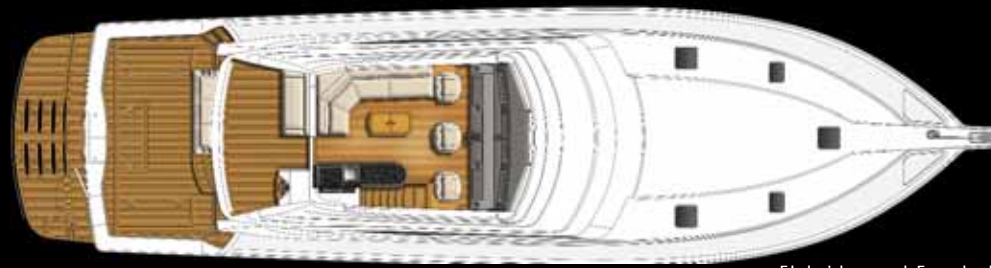

Flybridge and Foredeck

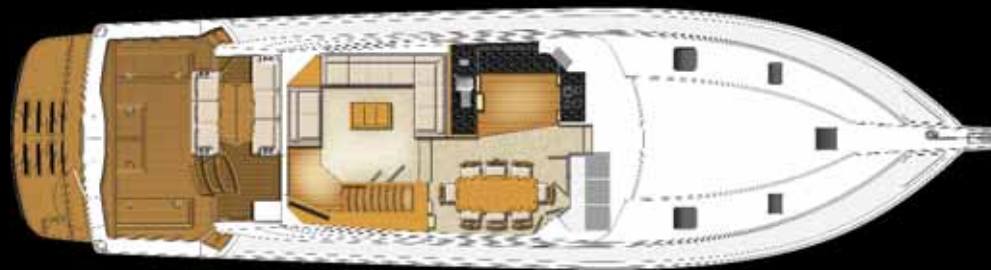

Main Saloon Deck



Standard Cabin Layout

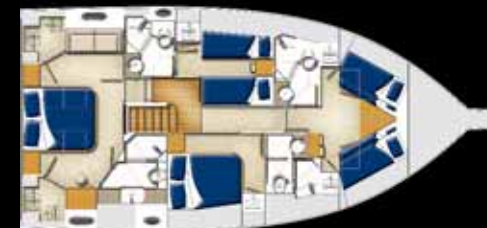

Option 1 - Cabin Layout

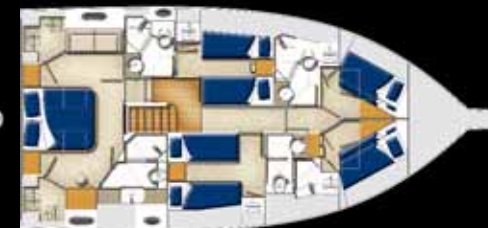

Option 2 - Cabin Layout



RIVIERA

www.riviera.com.au